

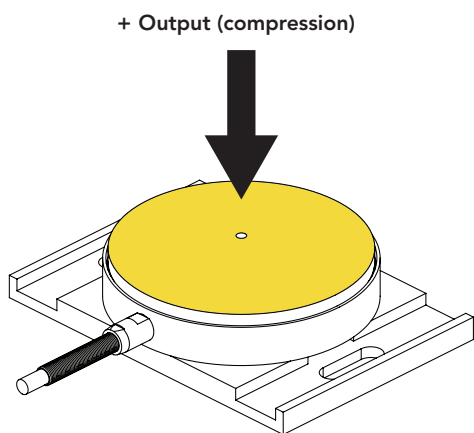

FEATURES

- Ideal for Automotive Applications involving brake testing
- Ideal for Aerospace Applications involving pedal force testing
- Spike resistant and highly resistant to off-axis loading
- Low Profile Height
- Removable Mounting Plate
- Light weight

Active end



SPECIFICATIONS

PERFORMANCE

| | |
|--------------------|--|
| Nonlinearity | ±0.25% of RO |
| Hysteresis | ±0.25% of RO |
| Nonrepeatability | ±0.1% of RO |
| Off Center Loading | ±1% or better @ 0.625 in [15.9 mm] from center |

ELECTRICAL

| | |
|-------------------------|---|
| Rated Output (RO) | 2 mV/V nom |
| Excitation (VDC or VAC) | 20 max |
| Bridge Resistance | 700 Ohm nom |
| Insulation Resistance | ≥500 MOhm @ 50 VDC |
| Connection | #24 AWG, 4 conductor, braided shielded PVC cable 15 ft [4.5 m] long |
| Wiring Code | WC1 |

MECHANICAL

| | |
|---------------|-------------------------|
| Weight | 16 oz (454 g) |
| Safe Overload | 150% of RO |
| Material | 17-4 PH stainless-steel |
| IP Rating | IP64 |

TEMPERATURE

| | |
|-------------------------|---------------------------------------|
| Operating Temperature | -60 to 200°F [-50 to 93°C] |
| Compensated Temperature | 60 to 160°F [15 to 72°C] |
| Temperature Shift Zero | ±0.003% of RO/°F [0.018% of RO/°C] |
| Temperature Shift Span | ±0.01% of Load/°F [0.018% of Load/°C] |

CALIBRATION

| | |
|-----------------------------|------------------|
| Calibration Test Excitation | 10 VDC |
| Calibration (standard) | 5-pt compression |
| Shunt Calibration Value | 100 kOhm |

DIMENSIONS inches [mm]

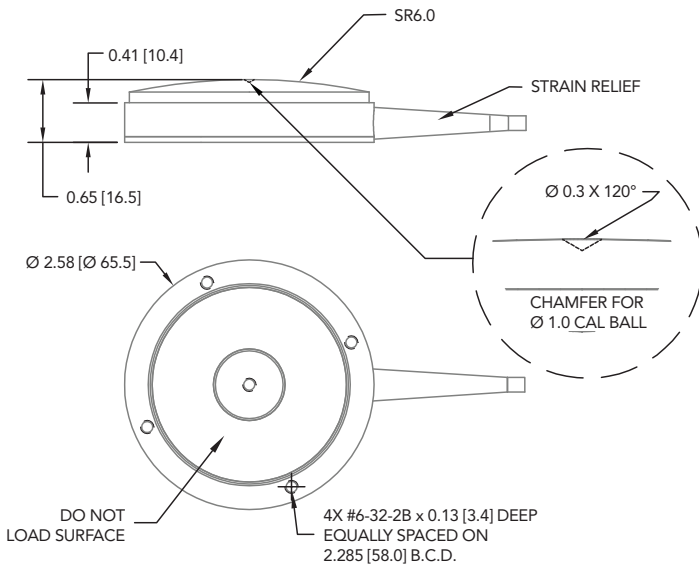

CAPACITIES

| ITEM # | lb | N | Deflection (in) | Natural Frequency (Hz) |
|----------|-----|------|-----------------|------------------------|
| FSH03184 | 300 | 1334 | 0.003 | 1500 |
| FSH02945 | 500 | 2224 | 0.003 | 2000 |

WIRING CODE (WC1 WITH SHIELD)

| | |
|--------|--------------|
| RED | + EXCITATION |
| BLACK | - EXCITATION |
| GREEN | + SIGNAL |
| WHITE | - SIGNAL |
| SHIELD | FLOATING |

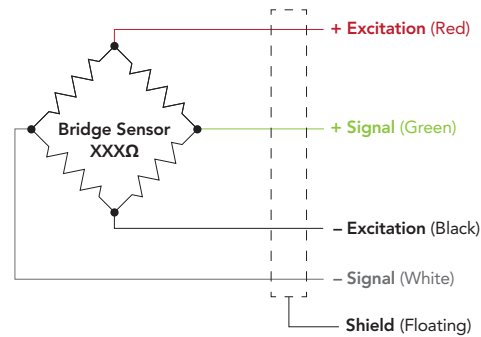

MOUNTING PLATES (ALUMINUM, RED ANODIZED)

ROUND PLATE

ITEM# MCP01098

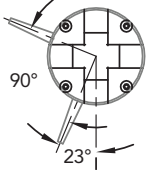

SENSOR CAN BE ROTATED AT 90° INCREMENTS

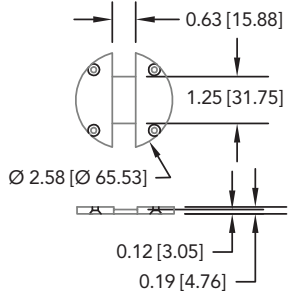

RECTANGULAR PLATE

ITEM# MCP00218

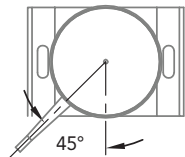

SENSOR CAN BE ROTATED AT 45° INCREMENTS

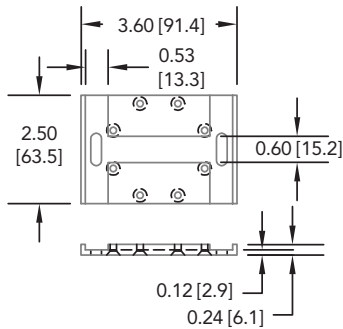

TYPICAL APPLICATION

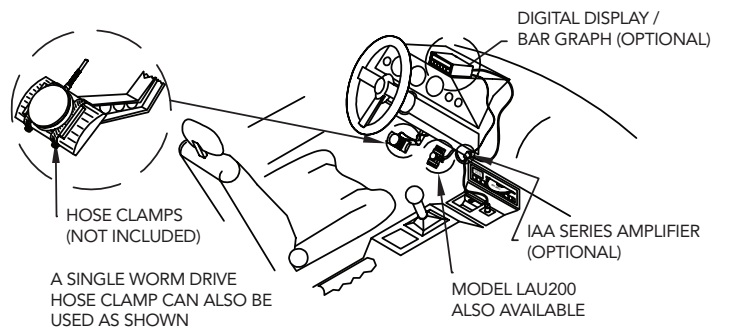

Model LAU220 includes (one of each)
Total Weight 2 lb [0.9 kg]

Mounting Plate
Item# MCP00218
Item# MCP01098
100 kohm shunt cal.
Carrying case

Drawing Number: FI1048-G

FUTEK reserves the right to modify its design and specifications without notice. Please visit www.futek.com/salesterms for complete terms and conditions.

10 Thomas, Irvine, CA 92618 USA

Tel: (949) 465-0900
Fax: (949) 465-0905

www.futek.com



SCIGATE AUTOMATION (S) PTE LTD

No. 1 Bukit Batok Street 22 #01-01 Singapore 659592
Tel: (65) 6561 0488 Fax: (65) 6562 0588
Email: sales@scigate.com.sg Web: www.scigate.com.sg
Business Hours: Monday - Friday 8.30am - 6.15pm



Z540-1

17025

9001

13485

U.S. Manufacturer