



PRODUCTS IN USE

Tri-Axial Load Cell (MTA400) paired with Instrumentation (IAA Analog Amplifier & USB Solutions)

APPLICATION SUMMARY

Wind tunnels are used in aerodynamic research to study the effects of air moving past solid objects referred to as models. A model is mounted onto a stationary tri-axial sensor which provides measurement of the pressure placed on the object at test.

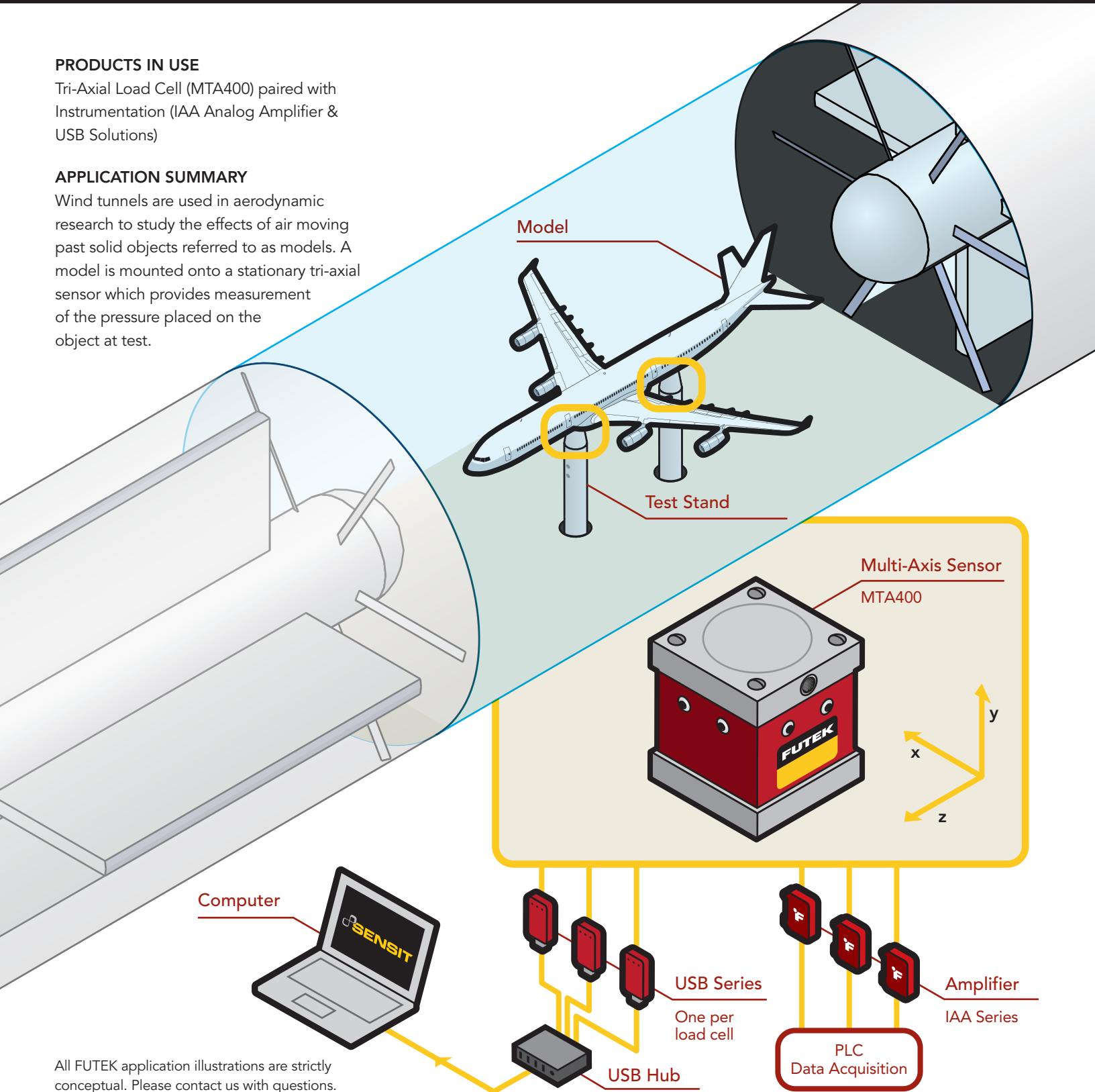

All FUTEK application illustrations are strictly conceptual. Please contact us with questions.

Sensor Solution Source

Load · Torque · Pressure · Multi Axis · Calibration · Instruments · Software

www.futek.com



SCIGATE AUTOMATION (S) PTE LTD

No.1 Bukit Batok Street 22 #01-01 Singapore 659592
 Tel: (65) 6561 0488 Fax: (65) 6562 0588
 Email: sales@scigate.com.sg Web: www.scigate.com.sg

Business Hours: Monday - Friday 8.30am - 6.15pm



U.S. Manufacturer